

### BALL ROLLER-ROUND HEAD, STUD TYPE

<b>ORDER:</b>	<b>TYPE-M</b>
	<b>EXAMPLE: MP005A10</b>

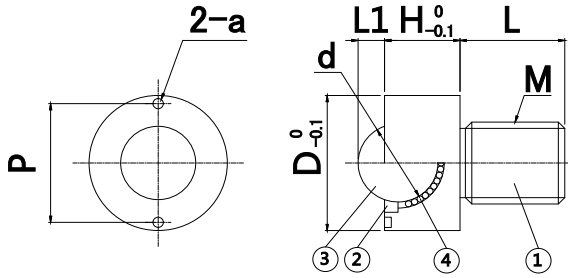

#### Materials

Type	Main Body (1)	Spacer (2)	Main Ball (3)	Sub Ball (4)
MP005A	SUS304		SUS440C(HRC55~)	
MP005B			POM	SUS440C(HRC55~)

#### Specifications

Part Number		L	L1	H	D	d	a	p	N(kgf)
Type	M								
MP005A	10	12	2.5	10	18.5	8.73	2	15.4	55(5.6)
	12	15	3.5	11	22	10.32		18.5	62(6.3)
MP005B	16	20	5.3	15	27	15.87	2.5	24	343(35)
	20	25	6.3	18	33	19.05		29.6	412(42)

### BALL ROLLER - PRESS FIT

<b>ORDER:</b>	<b>TYPE-D1</b>
	<b>EXAMPLE: MP006A14</b>

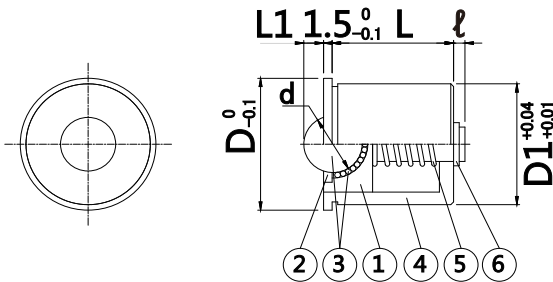

#### Materials

Type	Main Body (1)	Spacer (2)	Ball (3)	Casing (4)	Spring (5)	Retaining Ring (6)
MP006A	SUS304	SUS304	SUS440C	SUS304	SUS631J1	SUS304

#### Specifications

Part Number		D	L	L1	d	l	Load(N)	
Type	D1							
MP006A	14	16	14	1.5	5.56	1.5	23	30
	18	20	17	2.5	8.73	2	24	38
	22	24	21.5	3.5	10.32			55