

STAINLESS STEEL CABLE CLAMP (WITH BLACK RUBBER)

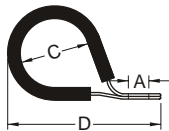
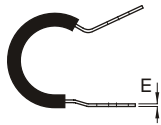
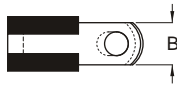

FIG-1

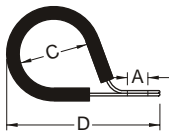
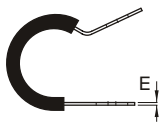

FIG-2

ITEM NO.	DIMENSION (mm)					FIG	PACKING BAG
	A	B	C	D	E		
CCSU-1/4	7.0	12.7	6.4(1/4")	34.0	0.8	1	100 PCS
CCSU-5/16	7.0	12.7	7.9(5/16")	34.7	0.8	1	
CCSU-7/16	7.0	12.7	11.1(7/16")	38.4	0.8	1	
CCSU-9/16	7.0	12.7	14.3(9/16")	43.5	0.8	1	
CCSU-3/4	7.0	12.7	19.1(3/4")	48.6	0.8	1	50 PCS
CCSU-7/8	7.0	12.7	22.2(7/8")	54.0	0.8	1	
CCSU-1	7.0	12.7	25.4(1")	59.0	0.8	1	100 PCS
CCSU-3/16	7.0	12.7	4.8(3/16")	30.0	0.8	2	
CCSU-3/8	7.0	12.7	9.5(3/8")	38.1	0.8	2	
CCSU-1/2	7.0	12.7	12.7(1/2")	43.1	0.8	2	
CCSU-5/8	7.0	12.7	15.9(5/8")	48.8	0.8	2	50 PCS
CCSU-1-1/4	7.0	12.7	31.8(1-1/4")	72.0	0.8	2	25 PCS
CCSU-1-1/2	7.0	12.7	36.7(1-1/2")	79.0	0.8	2	
CCSU-1-3/4	7.0	12.7	44.4(1-3/4")	86.0	0.8	2	
CCSU-2	7.0	12.7	50.8(2")	93.0	0.8	2	10 PCS
CCSU-2-1/2	7.0	12.7	63.5(2-1/2")	114.0	0.8	2	
CCSU-3	7.0	12.7	76.2(3")	128.0	0.8	2	

TERMINAL MATERIAL: STAINLESS STEEL
INSULATION MATERIAL: RUBBER