

**NON-INSULATED
BUTT CONNECTORS**

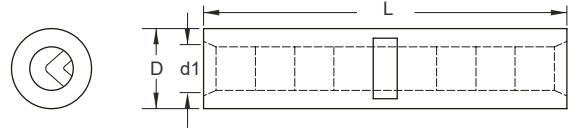

MAXIMUM ELECTRIC CURRENT:

A.W.G.	22	20	18	16	14	12	10
AMP.	9	12	17	18	30	35	50

TERMINAL MATERIAL: COPPER TUBULAR

WIRE RANGE A.W.G. mm ²	ITEM NO.	DIMENSION ^{inch} / _{mm}				CRIMPING TOOL	Q'TY BOX
	PARALLEL	L	D	d1	T		
22-16 A.W.G. 0.5-1.5 mm ²	BN1	.591 15.0	.130 3.3	.071 1.8	.028 0.7	IZUMI MODEL 5N18 WITH DIE INDEX NO:1.25 OR K.S. MODEL KST2000D-1322 LY-2045A WITH DIE INDEX NO:1.25	1000
16-14 A.W.G. 1.5-2.5 mm ²	BN2	.591 15.0	.154 3.9	.094 2.4	.028 0.7	IZUMI MODEL 5N18 WITH DIE INDEX NO:2 OR K.S. MODEL KST2000D-1322 LY-2045A WITH DIE INDEX NO:2	1000
12-10 A.W.G. 4-6 mm ²	BN5	.591 15.0	.213 5.4	.138 3.5	.035 0.9	IZUMI MODEL 5N18 WITH DIE INDEX NO:5.5 OR K.S. MODEL KST2000D-1322 LY-2045A WITH DIE INDEX NO:5.5	1000