



Application Guide
Intermediate Switches

CAT. NO.
KB31IA

Vivace

Thank you for choosing **Schneider Electric** Vivace Intermediate Switch. To ensure proper application of our product, please read through the following information before installation and use.

This application guide applies to the following Vivace products.



Cat No.	Description
KB311A	10AX 250V Intermediate Switch

SPECIFICATIONS

Voltage	: 250VAC
Dimension	: 86mm x 86mm
Mounting Centre	: 60.3mm
Compliance	: IEC 60669-1, MS IEC 60669-1, SS227

IMPORTANT NOTE

Please check your local wiring regulations before installation.

WIRING DIAGRAM

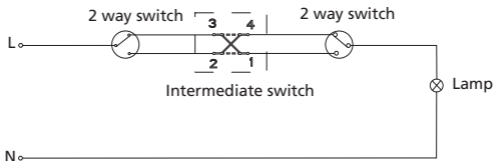

MOUNTING INSTRUCTION

Please refer to the following diagram for proper installation.

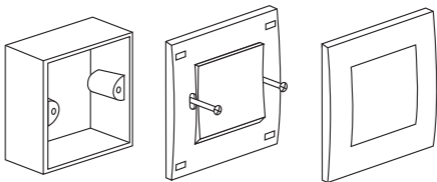

Remarks: For surround mounting, align the clip locks on the faceplate and press firm on the surround. Complete engagement of the clip locks is indicated by a clear "click" sound.

