

NON-INSULATED SPADE TERMINALS

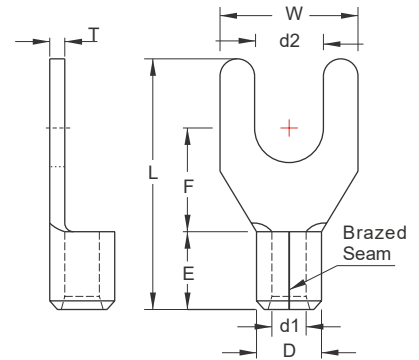

MAXIMUM ELECTRIC CURRENT:

A.W.G.	22	20	18	16	14
AMP.	9	12	17	18	30

TERMINAL MATERIAL: COPPER

WIRE RANGE A.W.G. mm ²	ITEM NO.		STUD SIZE		DIMENSION ^{inch} / _{mm}						CRIMPING TOOL	Q'TY BOX			
	BRAZED SEAM	BUTTED SEAM	d2		W	F	L	E	D	d1			T		
22-16 A.W.G. 0.5-1.5 mm ²	SNB1-3.2 *	SN1-3.2	#4	.126 3.2	.224 5.7	.256 6.5	.630 16.0	.189 4.8	.134 3.4	.067 1.7	.030 0.75	IZUMI MODEL 5N18 WITH DIE INDEX NO.:1.25 OR K.S. MODEL KST2000D-1322 WITH DIE INDEX NO.:22-18 OR K.S. MODEL KM-70L WITH DIE SET NO.:DIE-1322 WITH DIE INDEX NO.:22-18	1000		
	SNBS1-3.7 *	SNS1-3.7	#6	.146 3.7									1000		
	SNBL1-3.7 *	SNL1-3.7	#6	.146 3.7	.252 6.4								1000		
	SNBLL1-3.7	SNLL1-3.7	#6	.146 3.7	.283 7.2								1000		
	SNBS1-4 *	SNS1-4	#8	.169 4.3	.252 6.4								1000		
	SNBM1-4 *	SNM1-4	#8	.169 4.3	.283 7.2								1000		
	SNBL1-4 *	SNL1-4	#8	.169 4.3	.319 8.1								1000		
	SNBS1-5 *	SNS1-5	#10	.209 5.3	.374 9.5								1000		
	SNBL1-5 *	SNL1-5	#10	.209 5.3									1000		
	SNBS1-6 *	SNS1-6	1/4	.252 6.4	1000										
	SNBL1-6 *	SNL1-6	1/4	.252 6.4	.472 12.0								.433 11.0	.866 22.0	1000
	SNB1-8	SN1-8	5/16	.331 8.4	.551 14.0								.394 10.0	.831 21.1	1000
16-14 A.W.G. 1.5-2.5 mm ²	SNB2-3.2 *	SN2-3.2	#4	.126 3.2	.224 5.7	.256 6.5	.630 16.0	.189 4.8	.161 4.1	.091 2.3	.031 0.8	IZUMI MODEL 5N18 WITH DIE INDEX NO.:2 OR K.S. MODEL KST2000D-1322 WITH DIE INDEX NO.:16-14 OR K.S. MODEL KM-70L WITH DIE SET NO.:DIE-1322 WITH DIE INDEX NO.:16-14	1000		
	SNBS2-3.7 *	SNS2-3.7	#6	.146 3.7									1000		
	SNBL2-3.7 *	SNL2-3.7	#6	.146 3.7	.236 6.0								1000		
	SNBLL2-3.7	SNLL2-3.7	#6	.146 3.7	.283 7.2								1000		
	SNBS2-4 *	SNS2-4	#8	.169 4.3	.252 6.4								1000		
	SNBM2-4 *	SNM2-4	#8	.169 4.3	.283 7.2								1000		
	SNBL2-4 *	SNL2-4	#8	.169 4.3	.319 8.1								1000		
	SNBS2-5 *	SNS2-5	#10	.209 5.3	.366 9.3								1000		
	SNBL2-5 *	SNL2-5	#10	.209 5.3									1000		
	SNBS2-6 *	SNS2-6	1/4	.252 6.4	1000										
	SNBL2-6 *	SNL2-6	1/4	.252 6.4	.472 12.0								.433 11.0	.866 22.0	1000
	SNB2-8	SN2-8	3/8	.331 8.4	.551 14.0								.394 10.0	.823 20.9	1000
	SNB2-10	SN2-10	5/16	.413 10.5	.689 17.5								.512 13.0	.996 25.3	1000



ALL LISTED
*: ADDITIONAL CERTIFIED

**NON-INSULATED
SPADE TERMINALS**

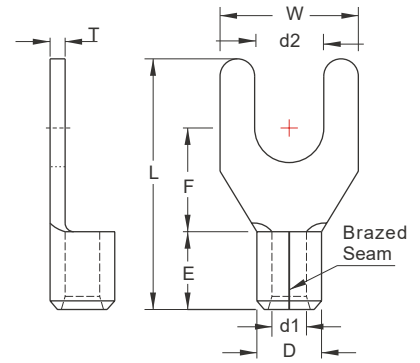

MAXIMUM ELECTRIC CURRENT:

A.W.G.	14	12	10	8	6
AMP.	30	35	50	70	95

TERMINAL MATERIAL: COPPER

WIRE RANGE A.W.G. mm ²	ITEM NO.		STUD SIZE		DIMENSION <small>inch mm</small>							CRIMPING TOOL	Q'TY BOX	
	BRAZED SEAM	BUTTED SEAM	d2		W	F	L	E	D	d1	T			
14-12 A.W.G. 2.5-4 mm ²	SNB3-3.7	SN3-3.7	#6	.146 3.7	.315 8.0								IZUMI MODEL 5N18 WITH DIE INDEX NO:5.5 OR K.S. MODEL KST2000D-1322 WITH DIE INDEX NO.:12-10 OR K.S. MODEL KM-70L WITH DIE SET NO:DIE-1322 WITH DIE INDEX NO.:12-10	1000
	SNBS3-4	SNS3-4	#8	.169 4.3	.283 7.2									1000
	SNB3-4	SN3-4	#8	.169 4.3	.315 8.0	.276 7.0	.709 18.0							1000
	SNB3-5	SN3-5	#10	.209 5.3	.315 8.0			.236 6.0	.201 5.1	.114 2.9	.039 1.0			1000
	SNB3-6	SN3-6	1/4	.252 6.4	.472 12.0	.358 9.1	.846 21.5							1000
12-10 A.W.G. 4-6 mm ²	SNBS5-3.7	SNS5-3.7	#6	.146 3.7	.283 7.2	.295 7.5	.685 17.4						IZUMI MODEL 5N18 WITH DIE INDEX NO:5.5 OR K.S. MODEL KST2000D-1322 WITH DIE INDEX NO.:12-10 OR K.S. MODEL KM-70L WITH DIE SET NO:DIE-1322 WITH DIE INDEX NO.:12-10	1000
	SNB5-3.7 *	SN5-3.7	#6	.146 3.7	.327 8.3	.276 7.0	.728 18.5							1000
	SNBSS5-4	SNSS5-4	#8	.169 4.3	.283 7.2	.295 7.5	.685 17.4							1000
	SNBS5-4 *	SNS5-4	#8	.169 4.3	.327 8.3									1000
	SNBL5-4 *	SNL5-4	#8	.169 4.3		.276 7.0	.720 18.3							1000
	SNB5-5 *	SN5-5	#10	.209 5.3	.354 9.0			.236 6.0	.220 5.6	.134 3.4	.039 1.0			1000
	SNBS5-6 *	SNS5-6	1/4	.252 6.4										1000
	SNBL5-6 *	SNL5-6	1/4	.252 6.4	.472 12.0	.472 12.0	.965 24.5							1000
SNB5-8	SN5-8	5/16	.331 8.4	.551 14.0	.413 10.5	.925 23.5						1000		
8 A.W.G. 8 mm ²	SNB8-5		#10	.209 5.3	.413 10.5	.319 8.1	.819 20.8						IZUMI MODEL 5N18 WITH DIE INDEX NO:8 OR K.S. MODEL KST2000D-1322 WITH DIE INDEX NO:8 OR K.S. MODEL KM-70L WITH DIE SET NO:DIE-1322 WITH DIE INDEX NO.:8	500
SNB8-6		1/4	.252 6.4	.425 10.8	.339 8.6	.886 22.5	.335 8.5	.283 7.2	.177 4.5	.047 1.2		500		
6 A.W.G. 14 mm ²	SNB14-6		1/4	.252 6.4	.433 11.0	.421 10.7	1.004 25.5						IZUMI MODEL 9H-60 WITH DIE INDEX NO:14 OR K.S. MODEL LY-2045B WITH DIE INDEX NO:14	500
SNB14-8		5/16	.331 8.4	.543 13.8	.421 10.7	1.122 28.5	.413 10.5	.354 9.0	.228 5.8	.059 1.5		500		

UL cUL ALL LISTED
*: ADDITIONAL CERTIFIED

NON-INSULATED HEAVY DUTY (HD SERIES) SPADE TERMINALS

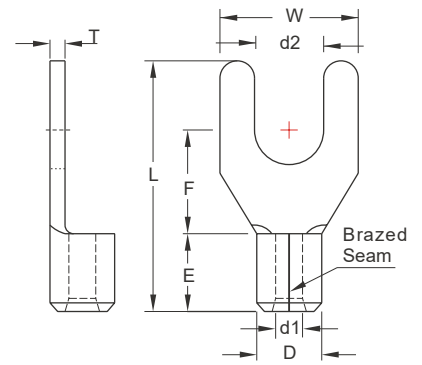

MAXIMUM ELECTRIC CURRENT:

A.W.G.	16	14
AMP.	18	30

TERMINAL MATERIAL: COPPER

WIRE RANGE A.W.G. mm ²	ITEM NO.		STUD SIZE	DIMENSION <small>inch mm</small>							CRIMPING TOOL	Q'TY BOX	
	BRAZED SEAM	BUTTED SEAM	d2	W	F	L	E	D	d1	T			
16-14 A.W.G.	SNBS2-3.7-HD*	SNS2-3.7-HD*	#6	.146 3.7	.283 7.2	.295 7.5	.685 17.4					IZUMI MODEL 5 OR K.S. MODEL KST2000D-1322 NO:12-10 OR LY-2045A LY-2045C LY-2045D WITH DIE INDEX NO:5.5	1000
	SNB2-3.7-HD	SN2-3.7-HD	#6	.146 3.7	.327 8.3	.276 7.0	.728 18.5						1000
	SNBSS2-4-HD*	SNSS2-4-HD*	#8	.169 4.3	.283 7.2	.295 7.5	.685 17.4						1000
	SNBS2-4-HD*	SNS2-4-HD*	#8	.169 4.3	.327 8.3								1000
1.5-2.5 mm ²	SNBL2-4-HD	SNL2-4-HD	#8	.169 4.3				.236 6.0	.220 5.6	.110 2.8	.051 1.3	1000	
	SNB2-5-HD	SN2-5-HD	#10	.209 5.3								.354 9.0	.276 7.0
	SNBS2-6-HD	SNS2-6-HD	1/4	.252 6.4								1000	
	SNBL2-6-HD*	SNL2-6-HD*	1/4	.252 6.4	.472 12.0	.472 12.0	.965 24.5					1000	
	SNB2-8-HD	SN2-8-HD	5/16	.331 8.4	.551 14.0	.413 10.5	.925 23.5					1000	

* : DEVELOPING ON DEMAND

**NON-INSULATED
LONG BARREL SPADE TERMINALS**

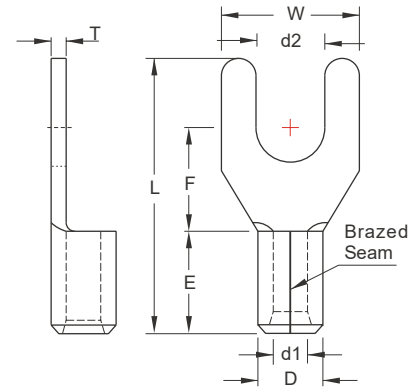

MAXIMUM ELECTRIC CURRENT:

A.W.G.	22	20	18	16	14
AMP.	9	12	17	18	30

TERMINAL MATERIAL: COPPER

WIRE RANGE A.W.G. mm ²	ITEM NO.		STUD SIZE		DIMENSION <small>inch mm</small>							CRIMPING TOOL	Q'TY BOX
	BRAZED SEAM	BUTTED SEAM	d2		W	F	L	E	D	d1	T		
22-16 A.W.G. 0.5-1.5 mm ²	ZSNB1-3.2	ZSN1-3.2	#4	.126 3.2	.224 5.7	.256 6.5	.689 17.5	.248 6.3	.134 3.4	.067 1.7	.030 0.75	IZUMI MODEL 5N18 WITH DIE INDEX NO:1.25 OR K.S. MODEL KST2000D-1322 WITH DIE INDEX NO.:22-18	1000
	ZSNBS1-3.7	ZSNS1-3.7	#6	.146 3.7									
	ZSNBL1-3.7	ZSNL1-3.7	#6	.146 3.7	.252 6.4								
	ZSNBLL1-3.7	ZSNLL1-3.7	#6	.146 3.7	.283 7.2								
	ZSNBS1-4	ZSNS1-4	#8	.169 4.3	.252 6.4								
	ZSNBM1-4	ZSNM1-4	#8	.169 4.3	.283 7.2								
	ZSNBL1-4	ZSNL1-4	#8	.169 4.3	.319 8.1								
	ZSNBS1-5	ZSNS1-5	#10	.209 5.3	.374 9.5								
	ZSNBL1-5	ZSNL1-5	#10	.209 5.3									
	ZSNBS1-6	ZSNS1-6	1/4	.252 6.4	.472 12.0								.433 11.0
ZSNBL1-6	ZSNL1-6	1/4	.252 6.4										
16-14 A.W.G. 1.5-2.5 mm ²	ZSNB2-3.2	ZSN2-3.2	#4	.126 3.2	.224 5.7	.256 6.5	.689 17.5	.248 6.3	.161 4.1	.091 2.3	.031 0.8	IZUMI MODEL 5N18 WITH DIE INDEX NO:2 OR K.S. MODEL KST2000D-1322 WITH DIE INDEX NO.:16-14	1000
	ZSNBS2-3.7	ZSNS2-3.7	#6	.146 3.7									
	ZSNBL2-3.7	ZSNL2-3.7	#6	.146 3.7	.236 6.0								
	ZSNBLL2-3.7	ZSNLL2-3.7	#6	.146 3.7	.283 7.2								
	ZSNBS2-4	ZSNS2-4	#8	.169 4.3	.252 6.4								
	ZSNBM2-4	ZSNM2-4	#8	.169 4.3	.283 7.2								
	ZSNBL2-4	ZSNL2-4	#8	.169 4.3	.319 8.1								
	ZSNBS2-5	ZSNS2-5	#10	.209 5.3	.366 9.3								
	ZSNBL2-5	ZSNL2-5	#10	.209 5.3									
	ZSNBS2-6	ZSNS2-6	1/4	.252 6.4	.472 12.0								.433 11.0
ZSNBL2-6	ZSNL2-6	1/4	.252 6.4										



ALL LISTED
 ◎ : NOT UL AND C-UL LISTED
 * : DEVELOPING ON DEMAND

**NON-INSULATED
LOCKING SPADE TERMINALS**

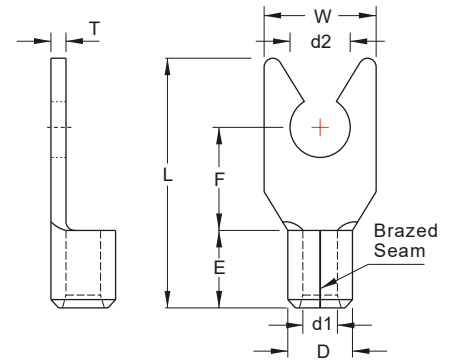

MAXIMUM ELECTRIC CURRENT:

A.W.G.	22	20	18	16	14	12	10
AMP.	9	12	17	18	30	35	50

TERMINAL MATERIAL: COPPER

WIRE RANGE A.W.G. mm ²	ITEM NO.		STUD SIZE		DIMENSION ^{inch} / _{mm}							CRIMPING TOOL	Q'TY BOX
	BRAZED SEAM	BUTTED SEAM	d2		W	F	L	E	D	d1	T		
22-16 A.W.G. 0.5-1.5 mm ²	LSNB1-3.2	LSN1-3.2	#4	.126 3.2	.252 6.4	.256 6.5	.630 16.0	.189 4.8	.134 3.4	.067 1.7	.030 0.75	IZUMI MODEL 5N18 WITH DIE INDEX NO:1.25 OR K.S. MODEL KST2000D-1322 LY-2045A WITH DIE INDEX NO:1.25	1000
	LSNB1-3.7	LSN1-3.7	#6	.146 3.7									
	LSNBS1-4	LSNS1-4	#8	.169 4.3	.283 7.2								
	LSNBL1-4	LSNL1-4	#8	.169 4.3	.319 8.1								
	LSNBS1-5	LSNS1-5	#10	.209 5.3									
	LSNBL1-5	LSNL1-5	#10	.209 5.3	.374 9.5								
16-14 A.W.G. 1.5-2.5 mm ²	LSNB2-3.2	LSN2-3.2	#4	.126 3.2	.236 6.0	.256 6.5	.630 16.0	.189 4.8	.161 4.1	.091 2.3	.031 0.8	IZUMI MODEL 5N18 WITH DIE INDEX NO:2 OR K.S. MODEL KST2000D-1322 LY-2045A WITH DIE INDEX NO:2	1000
	LSNB2-3.7	LSN2-3.7	#6	.146 3.7									
	LSNBL2-3.7	LSNL2-3.7	#6	.146 3.7	.283 7.2								
	LSNB2-4	LSN2-4	#8	.169 4.3									
	LSNBL2-4	LSNL2-4	#8	.169 4.3	.319 8.1								
	LSNBS2-5	LSNS2-5	#10	.209 5.3									
	LSNBL2-5	LSNL2-5	#10	.209 5.3	.366 9.3								
	LSNB2-6	LSN2-6	1/4	.252 6.4									
12-10 A.W.G. 4-6 mm ²	LSNBS5-3.7	LSNS5-3.7	#6	.146 3.7	.307 7.8	.276 7.0	.717 18.2	.236 6.0	.220 5.6	.134 3.4	.039 1.0	IZUMI MODEL 5N18 WITH DIE INDEX NO:5.5 OR K.S. MODEL KST2000D-1322 LY-2045A WITH DIE INDEX NO:5.5	1000
	LSNB5-3.7	LSN5-3.7	#6	.146 3.7									.327 8.3
	LSNB5-4	LSN5-4	#8	.169 4.3									
	LSNB5-5	LSN5-5	#10	.209 5.3	.354 9.0								
	LSNB5-6	LSN5-6	1/4	.252 6.4	.472 12.0								.472 12.0

UL cUL ALL LISTED

**NON-INSULATED
FLANGE SPADE TERMINALS**

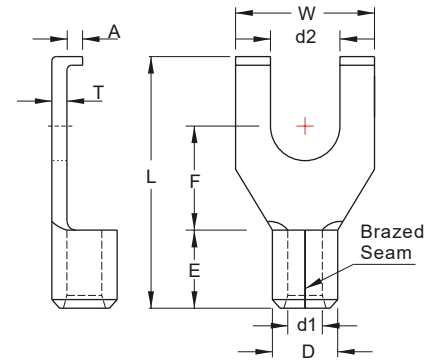

MAXIMUM ELECTRIC CURRENT:

A.W.G.	22	20	18	16	14	12	10
AMP.	9	12	17	18	30	35	50

TERMINAL MATERIAL: COPPER

WIRE RANGE A.W.G. mm ²	ITEM NO.		STUD SIZE		DIMENSION <small>inch mm</small>							CRIMPING TOOL	Q'TY BOX		
	BRAZED SEAM	BUTTED SEAM	d2		W	F	L	E	D	d1	A			T	
22-16 A.W.G. 0.5-1.5 mm ²	FSNBS1-2 [Ⓢ]	FSNS1-2 [Ⓢ]	#2	.087 2.2	.252 6.4	.205 5.2	.551 14.0	.189 4.8	.134 3.4	.067 1.7	.059 1.5	.030 0.75	IZUMI MODEL 5N18 WITH DIE INDEX NO:1.25 OR K.S. MODEL KST2000D-1322 LY-2045A WITH DIE INDEX NO:1.25	1000	
	FSNB1-3.2	FSN1-3.2	#4	.126 3.2	.295 7.5	.201 5.1								1000	
	FSNBS1-3.2	FSNS1-3.2	#4	.126 3.2	.252 6.4									1000	
	FSNB1-3.7	FSN1-3.7	#6	.146 3.7	.295 7.5	1000									
	FSNBS1-3.7	FSNS1-3.7	#6	.146 3.7	.252 6.4	1000									
	FSNBL1-3.7	FSNL1-3.7	#6	.146 3.7	.335 8.5	.283 7.2								.768 19.5	1000
	FSNB1-4	FSN1-4	#8	.169 4.3	.295 7.5	.201 5.1								.551 14.0	1000
	FSNBL1-4	FSNL1-4	#8	.169 4.3	.335 8.5	.283 7.2								.768 19.5	1000
	FSNB1-5	FSN1-5	#10	.209 5.3	.295 7.5	.201 5.1								.551 14.0	1000
	FSNBL1-5	FSNL1-5	#10	.209 5.3	.335 8.5	.283 7.2								.768 19.5	1000
16-14 A.W.G. 1.5-2.5 mm ²	FSNB2-3.7	FSN2-3.7	#6	.146 3.7	.295 7.5	.205 5.2	.571 14.5	.189 4.8	.161 4.1	.091 2.3	.059 1.5	.031 0.8	IZUMI MODEL 5N18 WITH DIE INDEX NO:2 OR K.S. MODEL KST2000D-1322 LY-2045A WITH DIE INDEX NO:2	1000	
	FSNBL2-3.7	FSNL2-3.7	#6	.146 3.7	.335 8.5	.283 7.2	.709 18.0							1000	
	FSNB2-4	FSN2-4	#8	.169 4.3	.295 7.5	.205 5.2	.571 14.5							1000	
	FSNBM2-4	FSNM2-4	#8	.169 4.3	.315 8.0	.268 6.8	.728 18.5							1000	
	FSNBL2-4	FSNL2-4	#8	.169 4.3	.335 8.5	.283 7.2	.709 18.0							1000	
	FSNB2-5	FSN2-5	#10	.209 5.3	.295 7.5	.205 5.2	.571 14.5							1000	
	FSNBL2-5	FSNL2-5	#10	.209 5.3	.335 8.5	.283 7.2	.709 18.0							1000	
12-10 A.W.G. 4-6 mm ²	FSNB5-3.7	FSN5-3.7	#6	.146 3.7	.335 8.5	.295 7.5	.787 20.0	.236 6.0	.220 5.6	.134 3.4	.059 1.5	.039 1.0	IZUMI MODEL 5N18 WITH DIE INDEX NO:5.5 OR K.S. MODEL KST2000D-1322 LY-2045A WITH DIE INDEX NO:5.5	1000	
	FSNBS5-3.7	FSNS5-3.7	#6	.146 3.7	.299 7.6	.244 6.2	.728 18.5							1000	
	FSNB5-4	FSN5-4	#8	.169 4.3	.335 8.5	.295 7.5	.787 20.0							1000	
	FSNBS5-4	FSNS5-4	#8	.169 4.3	.299 7.6	.244 6.2	.728 18.5							1000	
	FSNB5-5	FSN5-5	#10	.209 5.3	.335 8.5	.295 7.5	.787 20.0							1000	
	FSNBS5-5	FSNS5-5	#10	.209 5.3	.299 7.6	.244 6.2	.728 18.5							1000	

UL cUL ALL LISTED
Ⓢ : NOT UL AND C-UL LISTED

**NON-INSULATED
LONG BARREL FLANGE SPADE TERMINALS**

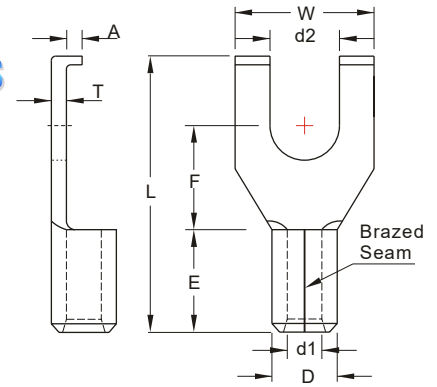

MAXIMUM ELECTRIC CURRENT:

A.W.G.	22	20	18	16	14
AMP.	9	12	17	18	30

TERMINAL MATERIAL: COPPER

WIRE RANGE A.W.G. mm ²	ITEM NO.		STUD SIZE	DIMENSION <small>inch mm</small>								CRIMPING TOOL	Q'TY BOX		
	BRAZED SEAM	BUTTED SEAM		d2	W	F	L	E	D	d1	A			T	
22-16 A.W.G. 0.5-1.5 mm ²	ZFSNBS1-2 ^{**Ⓞ}	ZFSNS1-2 ^{**Ⓞ}	#2	.087 2.2	.252 6.4	.205 5.2	.610 15.5	.248 6.3	.134 3.4	.067 1.7	.059 1.5	.030 0.75	IZUMI MODEL 5N18 WITH DIE INDEX NO.:1.25 OR K.S. MODEL KST2000D-1322 WITH DIE INDEX NO.:22-18	1000	
	ZFSNB1-3.2 ^{**Ⓞ}	ZFSN1-3.2 ^{**Ⓞ}	#4	.126 3.2	.295 7.5	.201 5.1								1000	
	ZFSNBS1-3.2 ^{**Ⓞ}	ZFSNS1-3.2 ^{**Ⓞ}	#4	.126 3.2	.252 6.4									1000	
	ZFSNB1-3.7	ZFSN1-3.7	#6	.146 3.7	.295 7.5	1000									
	ZFSNBS1-3.7 [Ⓞ]	ZFSNS1-3.7 [Ⓞ]	#6	.146 3.7	.252 6.4	1000									
	ZFSNBL1-3.7	ZFSNL1-3.7	#6	.146 3.7	.335 8.5	.283 7.2								.827 21.0	1000
	ZFSNB1-4	ZFSN1-4	#8	.169 4.3	.295 7.5	.201 5.1								.610 15.5	1000
	ZFSNBL1-4 ^{**Ⓞ}	ZFSNL1-4 ^{**Ⓞ}	#8	.169 4.3	.335 8.5	.283 7.2								.827 21.0	1000
	ZFSNB1-5	ZFSN1-5	#10	.209 5.3	.295 7.5	.201 5.1								.610 15.5	1000
	ZFSNBL1-5 ^{**Ⓞ}	ZFSNL1-5 ^{**Ⓞ}	#10	.209 5.3	.335 8.5	.283 7.2								.827 21.0	1000
16-14 A.W.G. 1.5-2.5 mm ²	ZFSNB2-3.7	ZFSN2-3.7	#6	.146 3.7	.295 7.5	.205 5.2	.630 16.0	.248 6.3	.161 4.1	.091 2.3	.059 1.5	.031 0.8	IZUMI MODEL 5N18 WITH DIE INDEX NO.:2 OR K.S. MODEL KST2000D-1322 WITH DIE INDEX NO.:16-14	1000	
	ZFSNBL2-3.7 ^{**Ⓞ}	ZFSNL2-3.7 ^{**Ⓞ}	#6	.146 3.7	.335 8.5	.283 7.2	.768 19.5							1000	
	ZFSNB2-4	ZFSN2-4	#8	.169 4.3	.295 7.5	.205 5.2	.630 16.0							1000	
	ZFSNBM2-4 ^{**Ⓞ}	ZFSNM2-4 ^{**Ⓞ}	#8	.169 4.3	.315 8.0	.268 6.8	.788 20.0							1000	
	ZFSNBL2-4 ^{**Ⓞ}	ZFSNL2-4 ^{**Ⓞ}	#8	.169 4.3	.335 8.5	.283 7.2	.768 19.5							1000	
	ZFSNB2-5	ZFSN2-5	#10	.209 5.3	.295 7.5	.205 5.2	.630 16.0							1000	
	ZFSNBL2-5	ZFSNL2-5	#10	.209 5.3	.335 8.5	.283 7.2	.768 19.5							1000	



ALL LISTED

Ⓞ : NOT UL AND C-UL LISTED

** : DEVELOPING ON DEMAND