



# W 6004

## Stainless steel deep groove ball bearing

Stainless steel single row deep groove ball bearings provide greater chemical and corrosion resistance. As with deep groove ball bearings generally, they are particularly versatile, have low friction and are optimized for low noise and low vibration, which enables high rotational speeds. They accommodate radial and axial loads in both directions, are easy to mount, and require less maintenance than many other bearing types.

- Greater chemical and corrosion resistance
- Simple, versatile and robust design
- Low friction and high-speed capability
- Accommodate radial and axial loads in both directions
- Require little maintenance

## Overview

### Dimensions

Bore diameter	0.787 in
Outside diameter	1.654 in
Width	0.472 in

### Performance

Basic dynamic load rating	1 812 lbf
Basic static load rating	1 124 lbf
Limiting speed	24 000 r/min
Reference speed	38 000 r/min

### Properties

Bore type	Cylindrical
Cage	Sheet metal
Coating	Without
Filling slots	Without
Locating feature, bearing outer ring	None
Lubricant	None
Matched arrangement	No
Material, bearing	Stainless steel
Number of rows	1
Radial internal clearance	CN
Relubrication feature	Without
Sealing	Without

# Technical Specification

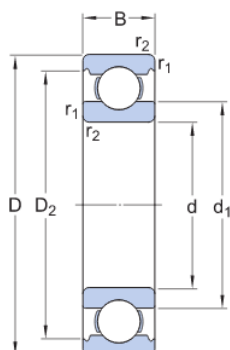

## Dimensions

d	0.787 in	Bore diameter
D	1.654 in	Outside diameter
B	0.472 in	Width
d <sub>1</sub>	≈ 1.087 in	Shoulder diameter
D <sub>2</sub>	≈ 1.526 in	Recess diameter
r <sub>1,2</sub>	min. 0.024 in	Chamfer dimension

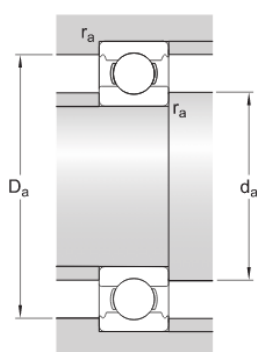

## Abutment dimensions

d <sub>a</sub>	min. 0.945 in	Diameter of shaft abutment
D <sub>a</sub>	max. 1.555 in	Diameter of housing abutment
r <sub>a</sub>	max. 0.024 in	Radius of shaft or housing fillet

## Calculation data

Basic dynamic load rating	C	1 812 lbf
Basic static load rating	C <sub>0</sub>	1 124 lbf
Fatigue load limit	P <sub>u</sub>	48 lbf
Reference speed		38 000 r/min
Limiting speed		24 000 r/min
Minimum load factor	k <sub>r</sub>	0.03
Calculation factor	f <sub>0</sub>	13.9

## Mass

Mass bearing	0.134 lb
--------------	----------

## Tolerance class

Dimensional tolerances	Normal
Radial run-out	Normal

# Terms and conditions

By accessing and using this website / app owned and published by AB SKF (publ.) (556007-3495 · Gothenburg) ("SKF"), you agree to the following terms and conditions:

## Warranty Disclaimer and Limitation of Liability

Although every care has been taken to assure the accuracy of the information on this website / app, SKF provides this information "AS IS" and DISCLAIMS ALL WARRANTIES, EXPRESS OR IMPLIED, INCLUDING, BUT NOT LIMITED TO, IMPLIED WARRANTIES OF MERCHANTABILITY AND FITNESS FOR A PARTICULAR PURPOSE. You acknowledge that your use of this website / app is at your sole risk, that you assume full responsibility for all costs associated with use of this website / app, and that SKF shall not be liable for any direct, incidental, consequential, or indirect damages of any kind arising out of your access to, or use of the information or software made available on this website / app. Any warranties and representations in this website / app for SKF products or services that you purchase or use will be subject to the agreed upon terms and conditions in the contract for such product or service. Further, for non-SKF websites / apps that are referenced in our website / app or where a hyperlink appears, SKF makes no warranties concerning the accuracy or reliability of the information in these websites / apps and assumes no responsibility for material created or published by third parties contained therein. In addition, SKF does not warrant that this website / app or these other linked websites / apps are free from viruses or other harmful elements.

## Copyright

Copyright in this website / app copyright of the information and software made available on this website / app rest with SKF or its licensors. All rights are reserved. All licensed material will reference the licensor that has granted SKF the right to use the material. The information and software made available on this website / app may not be reproduced, duplicated, copied, transferred, distributed, stored, modified, downloaded or otherwise exploited for any commercial use without the prior written approval of SKF. However, it may be reproduced, stored and downloaded for use by individuals without prior written approval of SKF. Under no circumstances may this information or software be supplied to third parties.

This website /app includes certain images used under license from Shutterstock, Inc.

## Trademarks and Patents

All trademarks, brand names, and corporate logos displayed on the website / app are the property of SKF or its licensors, and may not be used in any way without prior written approval by SKF. All licensed trademarks published on this website / app reference the licensor that has granted SKF the right to use the trademark. Access to this website / app does not grant to the user any license under any patents owned by or licensed to SKF.

## Changes

SKF reserves the right to make changes or additions to this website / app at any time.