

| Overall length | Thread length | Position on basic dia. | Shank dia. | Size of square | Length of square |
|----------------|---------------|------------------------|------------|----------------|------------------|
| L              | ℓ             | ℓg                     | Ds         | K              | ℓk               |

- ① Spiral Fluted Taps (for blind hole)
- ② Spiral Fluted Taps (for through hole)
- ③ Spiral Pointed Taps (for through hole)
- ④ Hand Taps
- ⑤ Cemented Carbide Taps
- ⑥ Roll Taps
- ⑦ Special Thread Taps (Simple inspection tools)
- ⑧ Pipe Taps
- ⑨ Thread Mills (Premium Thread Mills)
- ⑩ Dies
- ⑪ Center Drills (Centering Tools)
- ⑫ Precision Machinery/ Medical Surgical Instruments



## LS-PT

Long Shank Hand Taps for Taper Pipe Threads Long (ℓg) Type



### Specification



■ The LS-PT is a long shank tapered pipe thread tap and is used for products whose main purpose is the tightness of threaded parts in connection with pipe parts etc.

### Tapping Speeds depending on Materials

|                              |                            |                     |
|------------------------------|----------------------------|---------------------|
| Medium carbon steels<br>中炭素鋼 | High carbon steels<br>高炭素鋼 | Alloy steels<br>合金鋼 |
| ~5<br>(m/min)                | ~5<br>(m/min)              | ~5<br>(m/min)       |

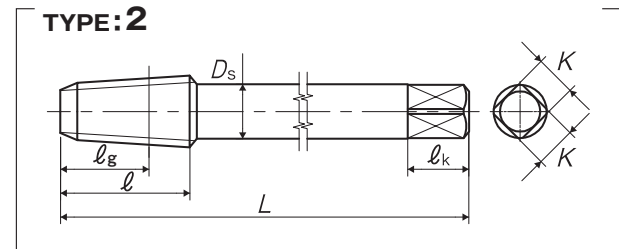
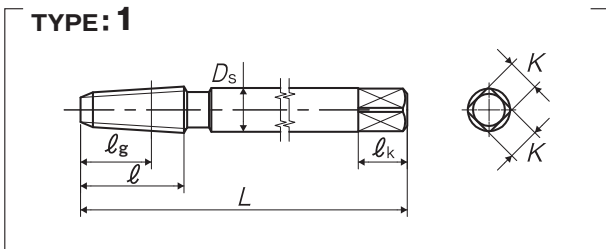

Segment : 1G

| Size             | Class | Code      | Chamfer | Basic major dia (mm) | L (mm) | ℓ (mm) | ℓg (mm) | Ds (mm) | K (mm) | ℓk (mm) | No. of flutes | TYPE | MSRP                   |
|------------------|-------|-----------|---------|----------------------|--------|--------|---------|---------|--------|---------|---------------|------|------------------------|
| For Pipe Threads |       |           |         |                      |        |        |         |         |        |         |               |      |                        |
| PT 1/16-28       | II    | L10T01K-8 | 2.5P    | 7.723                | 100    | 19     | 13      | 8       | 6      | 9       | 4             | 1    | ¥ 8,590 <sup>**</sup>  |
| PT 1/8-28        | II    | L10T02K   | 2.5P    | 9.728                | 100    | 19     | 13      | 8       | 6      | 9       | 4             | 2    | ¥ 8,590                |
| PT 1/8-28        | II    | L15T02K   | 2.5P    | 9.728                | 150    | 19     | 13      | 8       | 6      | 9       | 4             | 2    | ¥ 13,700               |
| PT 1/8-28        | II    | L20T02K   | 2.5P    | 9.728                | 200    | 19     | 13      | 8       | 6      | 9       | 4             | 2    | ¥ 19,600 <sup>**</sup> |
| PT 1/4-19        | II    | L10T04-   | 2.5P    | 13.157               | 100    | 28     | 21      | 11      | 9      | 12      | 4             | 2    | ¥ 9,270                |
| PT 1/4-19        | II    | L15T04-   | 2.5P    | 13.157               | 150    | 28     | 21      | 11      | 9      | 12      | 4             | 2    | ¥ 14,000               |
| PT 1/4-19        | II    | L20T04-   | 2.5P    | 13.157               | 200    | 28     | 21      | 11      | 9      | 12      | 4             | 2    | ¥ 19,800 <sup>**</sup> |
| PT 3/8-19        | II    | L10T06-   | 2.5P    | 16.662               | 100    | 28     | 21      | 14      | 11     | 14      | 4             | 2    | ¥ 15,700               |
| PT 3/8-19        | II    | L12T06-   | 2.5P    | 16.662               | 120    | 28     | 21      | 14      | 11     | 14      | 4             | 2    | ¥ 16,100 <sup>**</sup> |
| PT 3/8-19        | II    | L15T06-   | 2.5P    | 16.662               | 150    | 28     | 21      | 14      | 11     | 14      | 4             | 2    | ¥ 23,000               |
| PT 3/8-19        | II    | L20T06-   | 2.5P    | 16.662               | 200    | 28     | 21      | 14      | 11     | 14      | 4             | 2    | ¥ 32,500 <sup>**</sup> |
| PT 1/2-14        | II    | L15T08Q   | 2.5P    | 20.955               | 150    | 35     | 25      | 18      | 14     | 17      | 4             | 2    | ¥ 27,700               |
| PT 1/2-14        | II    | L20T08Q   | 2.5P    | 20.955               | 200    | 35     | 25      | 18      | 14     | 17      | 4             | 2    | ¥ 39,400 <sup>**</sup> |
| PT 3/4-14        | II    | L15T12Q   | 2.5P    | 26.441               | 150    | 35     | 25      | 23      | 17     | 20      | 4             | 2    | ¥ 41,600               |
| PT 3/4-14        | II    | L20T12Q   | 2.5P    | 26.441               | 200    | 35     | 25      | 23      | 17     | 20      | 4             | 2    | ¥ 50,400 <sup>**</sup> |
| PT 1 -11         | II    | L15T16U   | 2.5P    | 33.249               | 150    | 45     | 32      | 26      | 21     | 24      | 5             | 2    | ¥ 58,600               |
| PT 1 -11         | II    | L20T16U   | 2.5P    | 33.249               | 200    | 45     | 32      | 26      | 21     | 24      | 5             | 2    | ¥ 71,500 <sup>**</sup> |
| PT 1 1/4-11      | II    | L20T20U   | 2.5P    | 41.910               | 200    | 45     | 32      | 32      | 26     | 30      | 5             | 2    | ¥107,000 <sup>**</sup> |
| PT 1 1/2-11      | II    | L20T24U   | 2.5P    | 47.803               | 200    | 45     | 32      | 38      | 29     | 32      | 6             | 2    | ¥136,000 <sup>**</sup> |
| PT 2 -11         | II    | L20T32U   | 2.5P    | 59.614               | 200    | 50     | 35      | 46      | 35     | 38      | 6             | 2    | ¥193,000 <sup>**</sup> |