

VINYL-INSULATED STAR RING TERMINALS (BRASS)

MAXIMUM ELECTRIC CURRENT:

A.W.G.	22	20	18	16	14	12	10
AMP.	3	4	7	10	15	35	50

MAXIMUM ELECTRICAL RATING: 105°C 600 VOLTS MAX.

INSULATION MATERIAL: VINYL

INSULATION COLOR:

22-16 A.W.G.: RED 16-14 A.W.G.: BLUE 12-10 A.W.G.: YELLOW

TERMINAL MATERIAL: BRASS

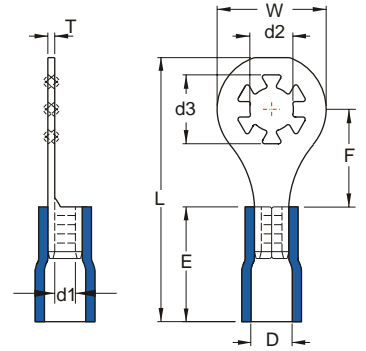

WIRE RANGE A.W.G. mm ²	ITEM NO.	STUD SIZE		DIMENSION ^{inch} / _{mm}							CRIMPING TOOL	Q'TY BOX	
		d2		W	F	L	d3	E	D	d1			T
22-18 A.W.G. 0.5-0.75 mm ²	STRV1-3.7	#6	.146 3.7	.374 9.5	.335 8.5	.898 22.8	.236 6.0	.394 10.0	.150 3.8	.067 1.7	.024 0.6	K.S. MODEL KST2000A WITH DIE INDEX COLOR:RED	1000
	STRV1-4	#8	.169 4.3				.264 6.7						1000
	STRV1-5	#10	.201 5.1				.303 7.7						1000
16-14 A.W.G. 1.5-2.5 mm ²	STRV2-3.2	#4	.126 3.2	.315 8.0	.335 8.5	.874 22.2	.217 5.5	.394 10.0	.177 4.5	.091 2.3	.024 0.6	K.S. MODEL KST2000A WITH DIE INDEX COLOR:BLUE	1000
	STRV2-3.7	#6	.146 3.7	.236 6.0	1000								
	STRV2-4	#8	.169 4.3	.264 6.7	500								
	STRV2-5	#10	.201 5.1	.303 7.7	500								
12-10 A.W.G. 4-6 mm ²	STRV5-3.7	#6	.146 3.7	.374 9.5	.327 8.3	1.016 25.8	.236 6.0	.512 13.0	.252 6.4	.134 3.4	.024 0.6	K.S. MODEL KST2000A WITH DIE INDEX COLOR:YELLOW	1000
	STRV5-4	#8	.169 4.3				.264 6.7						1000
	STRV5-5	#10	.201 5.1				.303 7.7						1000

ALL LISTED

